

Our Case Number: ABP-316272-23
Planning Authority Reference Number:

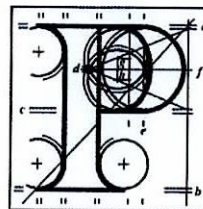

**An
Bord
Pleanála**

Dolores (Dee) Gaffney
16 Terenure Road East
Rathgar
Dublin 6
D06A2F9

Date: 17 August 2023

Re: Bus Connects Templeogue/Rathfarnham to City Centre Core Bus Corridor Scheme
Templeogue/Rathfarnham to City Centre

Dear Sir / Madam,

An Bord Pleanála has received your recent submission in relation to the above-mentioned proposed road development and will take it into consideration in its determination of the matter. Please accept this letter as a receipt for the fee of €50 that you have paid.

Please note that the proposed road development shall not be carried out unless the Board has approved it or approved it with modifications.

The Board has also received an application for confirmation of a compulsory purchase order which relates to this proposed road development. The Board has absolute discretion to hold an oral hearing in respect of any application before it, in accordance with section 218 of the Planning and Development Act 2000, as amended. Accordingly, the Board will inform you in due course on this matter. The Board shall also make a decision on both applications at the same time.

If you have any queries in relation to this matter please contact the undersigned officer of the Board at laps@pleanala.ie

Please quote the above-mentioned An Bord Pleanála reference number in any correspondence or telephone contact with the Board.

Yours faithfully,

Eirnear Reilly

Executive Officer
Direct Line: 01-8737184

HA02A

Teil	Tel	(01) 858 8100
Glaio Áitiúil	LoCall	1890 275 175
Facs	Fax	(01) 872 2684
Láithreán Gréasáin	Website	www.pleanala.ie
Ríomhphost	Email	bord@pleanala.ie

64 Sráid Maoilbhríde	64 Marlborough Street
Baile Átha Cliath 1	Dublin 1
D01 V902	D01 V902

Mrs. Dolores (Dee) Gaffney
16 Terenure Road East
Rathgar, Dublin 6
Co. Dublin
D06A2F9

Dear Sirs,

My name is Dee Gaffney and I live at 16 Terenure Road East, Rathgar, Dublin 6 (D06A2F9). I am making this submission in respect of the Templeogue/ Rathfarnham to City Centre Core Bus Corridor Scheme currently being planned by the National Transport Authority (NTA). Per the public notice available at <https://templeoquerathfarnhamscheme.ie>, inviting submissions regarding the bus route corridor (Ref. No. 316272) until the 15th of August 2023, I wish to make this submission which is accompanied by the relevant submission fee (€50). The purpose of this submission is express concern regarding the relocation of an existing bus stop to the front of my property which is a protected structure.

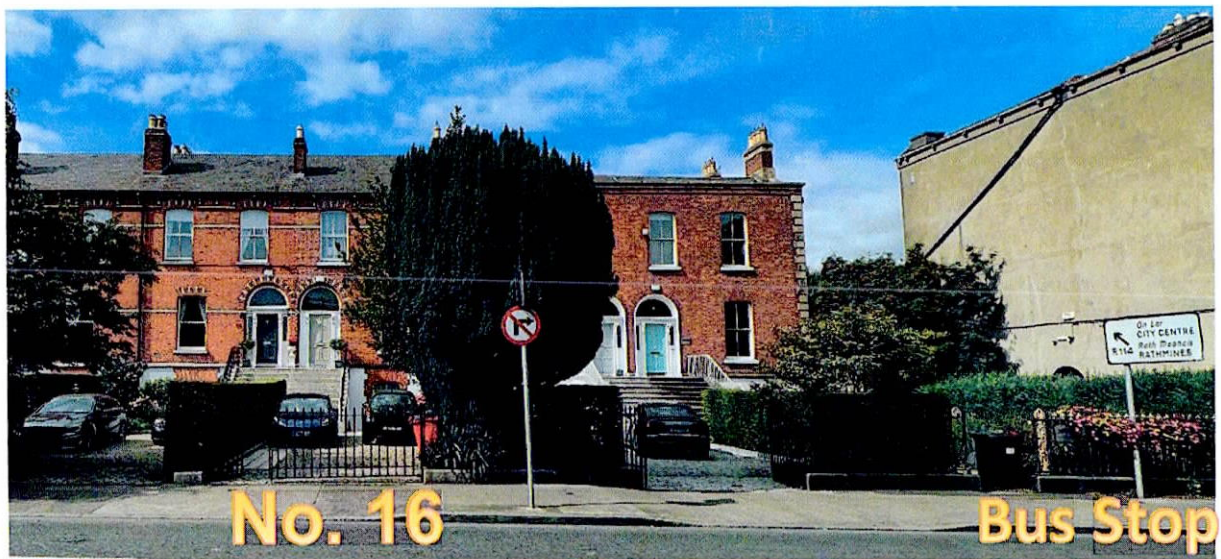

Figure 1 – Picture of my home at No. 16 Terenure Road East and the proposed location for the bus stop and related bus shelter.

I am currently 83 years old and purchased No. 16 Terenure Road East in 1986. I have lived at No. 16 Terenure Road East continuously for nearly forty years. Per the plans submitted to An Bord Pleanála (ABP), the bus stop located at No. 34 Terenure Road East is to be moved to the front gates of No. 12 Terenure Road East (also a protected structure with protected front gates) with a bus set down area directly in front of my home as seen below:

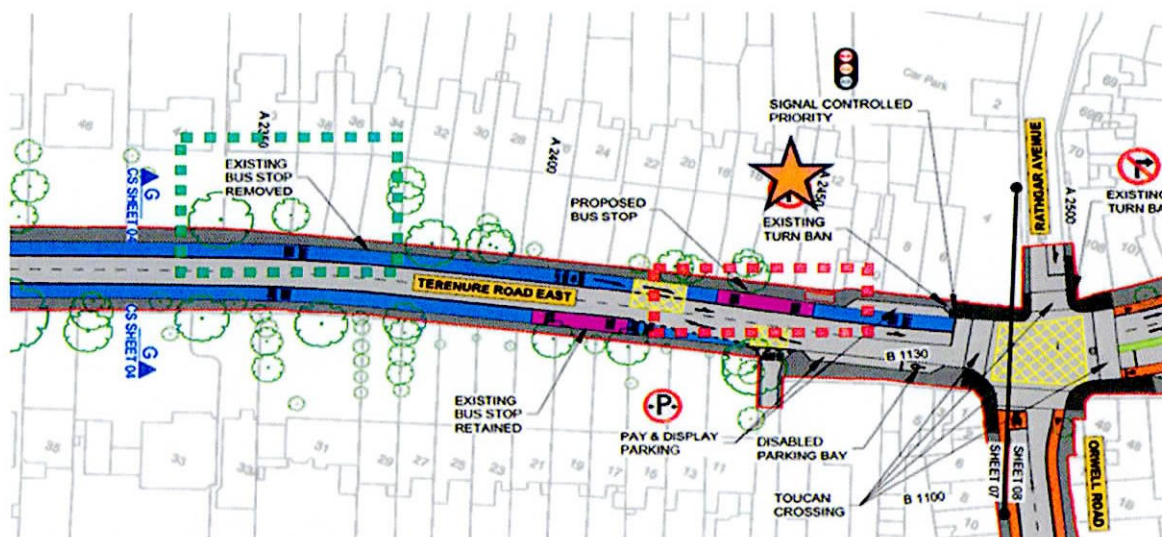

Figure 2 – Extract from Sheet 10 of the General Arrangement drawing illustrating the existing stop which is to be relocated (green dashed line).

My concerns with this proposed new location are as follows:

1. The Bus Stop Was Moved from This Location

In 1986, when I moved into No. 16 Terenure Road East, the bus stop currently located in front of No. 34 Terenure Road East was located at or very near the proposed location in front of No. 12 Terenure Road East. The former (and now proposed new) location of the bus stop caused congestion and foot traffic issues serious enough that a campaign by the neighbourhood to have the location moved was undertaken. After a long period of complaints, the NTA (or former body) moved the bus stop to its current location at No. 34 Terenure Road East. I cannot recall the exact year of the move, but it was very much welcomed by everyone within Rathgar and those passing through Rathgar.

a. Road Traffic

The right lane of Terenure Road East is used by motorists looking to turn right onto Highfield Road after the intersection of Orwell Road – it is not used to continue on into town. When the bus stop was located near the intersection of Orwell Road, the left-hand lane (which is used by motorists looking to continue into town) was blocked by each bus using the stop. This caused a traffic blockage which would gridlock the village with regularity. The traffic looking to make the right-hand turn onto Highfield Road would back up beyond the intersection with Orwell Road. Buses would stop for passengers and block the left-hand lane completely. With each stop, all traffic on Terenure Road East would come to a standstill. During peak hours, the backup of cars would start to grow and continue down Terenure Road East.

b. Foot Traffic

The footpath narrows for a row of parking spaces immediately after the proposed (and former) bus stop location. As people congregate waiting for the bus, the ability for people to walk into and out of the village (especially those with wheelchairs or buggies) becomes impeded as people block the available path.

For both the reasons above, after countless calls and complaints by the village, the stop was moved down the road. Motorists can overtake the stopped buses in the right lane and easily make it back to the left lane to continue their journey towards town. Pedestrians have the wider path around the bus shelter both before and after the location. After the bus stop was moved, there have been no complaints about the location

that I am aware of and everyone was pleased with the outcome. It should not be moved back to its former location.

2. No Consultation

Along with my neighbours, I participated in the NTA consultation process from the beginning. Proposed plans were made available by the NTA on two occasions, the second similar to the first but with modifications that I believe were based on the consultation feedback. The proposed bus stop move from No. 34 Terenure Road East to No. 12 Terenure Road East was not included in either of these publications. I only became aware of the proposed move when neighbours notified me that the plans submitted to ABP contained the bus stop move. There are others besides me that have been in the village long enough to have experienced the issues the proposed bus stop location causes. Had the NTA, or anyone, consulted us we could have told them why the bus stop was moved from this location in the first place. Instead, no notice of any kind has ever been provided to me.

3. Safety

The area in front of No. 12 Terenure Road East is used regularly by delivery vehicles supplying the local shops in the village. Every day large vans or trucks pull up onto the footpath as there is no loading zone before the intersection of Orwell Road. I do not think this will stop with the introduction of a bus shelter and on top of further blocking the footpath, someone is very likely to get hurt.

Further, it is difficult enough for me to drive into and out of my driveway with the current road traffic. The documents submitted to the NTA indicate that they expect 31 buses per hour at peak times to use the proposed bus stop at No. 12 Terenure Road East. Per the drawing submitted, the bus will park in front of my front gate blocking my exit. I have lived in my home at No. 16 Terenure Road East for almost forty years and do not wish to move, but I also do not wish to be trapped in my own driveway (or unable to return home) with a bus every other minute. In addition, as a tagged disabled driver and as I get older, I am concerned that impeded access will cause issues for any additional home care that I may require.

4. Listed Building

The O'Brien's Press located at No. 12 Terenure Road East have been publishing books out of the location for years. It is a listed building with original front railings that are also protected. The current location of the bus stop (at No. 34) is not in front of a protected structure. The NTA should not be allowed to erect a bus shelter in front of a period property with original gates to move a bus stop around 70 meters down the road from a more functional location. Rathgar has many period homes, buildings and features that its residents, and ABP, have worked hard to maintain. This should not be undermined by the unnecessary relocation of the bus stop.

The current proposed location by the NTA is repeating a mistake that was corrected long ago. I am asking that An Bord Pleanála maintain the bus stop at its current location so that the same issues do not arise a second time.

Respectfully submitted,

Dee Gaffney